

ISO/TS-16949
Certified
Automotive
Quality



Qualitäts-Felgenschlösser
PROFESSIONAL SAFETY LOCKS
ISO/TS-16949 Certified Automotive Quality

| | |
|--|-----------------------|
| E1* | E1/M* |
| StilBull 650 | ChromeSafe PRO |
| <p>*Identische Felgenschloss-Typen für StilBull und ChromeSafe. Für ChromeSafe zusätzliche Kennzeichnung ".../M".</p> <p>*Identical wheel lock types for StilBull and ChromeSafe. For ChromeSafe additional marking ".../M".</p> <p>*Идентичные типы болтов секреток StilBull и ChromeSafe. Для ChromeSafe есть дополнительная маркировка ".../M".</p> | |



ISO/TS-16949
Certified
Automotive
Quality

HEYNER
Germany

StilBull 650
HIGH QUALITY WHEEL LOCKS

Form / Gewicht / Qualität entsprechen den Original-Schrauben und -Muttern der Fahrzeug Erstausrüster (OEM) für alle Automobile (bis 650PS/600KW)

- Zertifizierte Qualitäts-Felgenschlösser
- Super Power
- 10.9 Stahl Qualität
- extra starkes 260Nm Drehmoment
- Lebenslange Garantie gegen Korrosion

SAFETY LOCKS (E1) **FORTELL-SEKRETKY** (E1/M)
Size, weight and quality like the original manufacturer car bolts (OEM) for all cars up to 650 HP.
Создан по качеству оригинальных комплектных болтов и гаек от производителя т.к. (OEM) для всех автомобилей (до 650 л/с/600кВт)

Typ

260 Nm TORQUE
CORROSION RESISTANCE
LIFETIME WARRANTY

PREMIUM QUALITY FOR AUTOMOBILES



Super Power 10.9 Stahl Qualität.
Extremes 260Nm Drehmoment.
Lebenslange Garantie gegen Korrosion.



Modelle
Models
Модель

Jahr
Year
Год

Stahlfelgen,
Steel Wheels
Стальные Диски

Original Alufelgen
Original Alloy Wheels
Оригинальные Алюминиевые Диски

Ersatzreifen
Spare Tire
Запасные Колеса

| Modelle Models Модель | Jahr Year Год | Stahlfelgen, Steel Wheels Стальные Диски | Original Alufelgen Original Alloy Wheels Оригинальные Алюминиевые Диски | Ersatzreifen Spare Tire Запасные Колеса |
|--|----------------------|--|---|---|
| ALFA ROMEO | | | | |
| 33 | 1 ^a Serie | G | - | |
| 33 | 2 ^a Serie | A | A | |
| 145, 146 | - | A | E1 | |
| GTV, Spider | - | - | E1 | |
| 155, 164 | - | E1 | E | |
| 156 | <2000 | G | G | |
| Alfa 159, Alfa Brera | 01/2005> | C1 | C1 | |
| 166, 147, 156, GT, GT Coupè | 2001> | A1 | A1 | |
| Crosswagon, Mito, Giulietta | - | A1 | A1 | |
| AUDI | | | | |
| 80, 90, 100, 200, Quattro, Coupè - | - | Z | ZA | |
| A1, A2, A3, A4, A5, A6, A7, A8, A4 All road, A6 All Road, TT Coupè, S3, S4, S5, S6, S8, TT Spider, R8, RS3, RS4, RS6 | - | ZA | ZA | |
| RS3, RS4, RS6 | | ZA | ZA | |
| Q7 | - | - | AL3R | |
| Q5, Q3 | 2008> | - | N.D. | |
| BMW | | | | |
| Serie 5, Serie 6, Serie 8, Z1, Z3, Z4 Z8, M3, M5, Roadster-S, X1 | - | I | I | |
| Serie 7 | <2002 | I | I | |
| Serie 7, X3 | 2003> | C2 | C2 | |
| Serie 7, Serie 6, Serie 5, X3, X6 | 10/2009> | N.D. | N.D. | |
| X5 | <04/2003 | - | W3 | |
| X5 | 05/2003-02/2007 | C3 | C3 | |
| X5 | 03/2007> | - | N.D. | |
| Serie 1, Serie 3 | <08/2011 | I | I | |
| Serie 1, Serie1 coupè, Serie 3 | 09/2011> | N.D. | N.D. | |
| CADILLAC | | | | |
| BLS | 11/2007> | - | I3 | |
| CHEVROLET | | | | |
| Nexia, Espero, Lanos | - | P | P | |
| Leganza | - | HA | - | |
| Matiz | - | RA2 | - | |
| Tacuma | - | - | H | |
| Kalos | 2003> | H | H | |
| Lacetti | 05/2004> | DC3 | - | |
| Epica, Captiva | 10/2006> | HA | HA | |
| Nubira | <2005 | P | P | |
| Nubira | 2006> | HA | HA | |
| Aveo | 09/2008-12/2010 | HA | HA | |
| Spark | 2009> | HA | HA | |
| Orlando, Cruze | 2011> | H | H | |
| Aveo | 2011> | HA | HA | |
| Malibù | 2011> | DC6 | DC6 | |
| CHRYSLER | | | | |

| | | | | |
|--|-----------|------|------|----|
| Neon | - | DC3 | H | |
| Stratus | - | - | H | |
| 300 M, PT Cruiser, Voyager, Grand Voyager | - | HA | HA | |
| Crossfire | - | - | SG | |
| 300 C | 06/2005> | AD1 | AD1 | |
| Sebring | 03/2007> | HA | HA | |
| CITROËN | | | | |
| AX | - | N.D. | A | |
| ZX, C15 | - | A | A | |
| Sinergie / Evasion, Jumpy | - | W2 | W2 | |
| Xsara | <2000 | A | AH1 | |
| CX, BX, XM, Saxo, Xantia | <2000 | A | AH | |
| Saxo, Xsara, Xsara Picasso Xantia, XM, Berlingo | 2001-2002 | A | AH4 | |
| Saxo, C3, Xsara, Xsara Picasso C5, Berlingo, C2, C4, C4 Picasso, Multispazio, C6, C3 Multispazio, DS3, DS4, DS5, C4 Aircross | 2003> | K | ZH4 | |
| C1 | - | I3 | AH6 | |
| C5 | <2002 | AH4 | AH4 | |
| C8 | - | C1 | C2 | |
| Jumper | - | W2 | W3 | |
| C-Crosser | 09/2007> | - | 382 | |
| Nemo | 01/2008> | A1 | - | |
| DACIA | | | | |
| Logan, Logan SW, Sandero, Duster, Lodgy, Dokker | - | I3 | I3 | |
| DAIHATSU | | | | |
| Applause, Domino, Feroza, | - | H1 | H1 | |
| Gran Move/Move, Cuore, Hijet | - | HA1 | - | |
| Sirion, YRV | 1998> | DC1 | DC1 | |
| Charade | <2002 | H1 | H1 | |
| Charade | 2003> | DC1 | DC1 | |
| Copen - | - | HA1 | HA1 | |
| Terios | <04/2006 | HA1 | HA1 | |
| Terios | 05/2006> | H1 | H1 | |
| Materia | 01/2007> | H1 | H1 | |
| Rocky 4x4 | - | H1 | H1 | H1 |
| DODGE | | | | |
| Caliber | 10/2006> | - | HA | |
| Viper | 2002> | - | AE | |
| Nitro | 10/2007> | - | AE | |
| Avenger | 03/2008> | - | HA | |
| Journey | 06/2008> | HA | HA | |
| DR | | | | |
| dr5 | - | - | 482 | |
| dr1, dr2 | 2010> | N.D. | N.D. | |
| FIAT | | | | |
| Tipo, Bravo, Brava, Punto, Punto Cabrio Marea, Tempra, Palio SW, Palio Pick-up | <1998 | G | E1 | |
| Croma | <1999 | G | E | |
| Seicento (except alloy wheels 14") | - | G | E1 | |
| Seicento Abarth | - | - | RA | |
| Uno | 1992> | A | E1 | |
| Coupè | - | E1 | E1 | |
| Uno Turbo IE | - | - | E | |
| Palio (except SW) | <2000 | A | E | |



Modelle
Models
Модель

| | Jahr Year Год | Stahlfelgen Steel Wheels Стальные Диски | Original Alufelgen Original Alloy Wheels Оригинальные Алюминиевые Диски | Ersatzreifen Spare Tire Запасные Колеса |
|---|---------------------|---|---|---|
| Barchetta | - | - | SH | |
| Ulysse | <2002 | W2 | W3 | |
| Ulysse | 2003> | C1 | C2 | |
| Bravo, Brava, Punto, Marea, Palio | 1999-2000 | G | G | |
| Multipla, Doblò, Stilo, Stilo SW, Bravo, Brava, Punto, Marea, Palio, Idea | 2001> | A1 | A1 | |
| Panda, Fiorino | <2002 | A | - | |
| Panda, Fiorino, Qubo, Linea | 2003> | A1 | A1 | |
| Grande Punto, Croma, Sedici Punto Evo, Punto 2012 | 11/2005> | I3 | I3 | |
| Cinquecento | <08/2007 | A | E1 | |
| 500 | 09/2007> | A1 | A1 | |
| Strada Pick-up | - | G | - | |
| Scudo | - | W2 | W3 | |
| Scudo | 2007> | K | K | |
| Ducato (wheel 15") | <2005 | W6 | W6 | |
| Ducato (wheel 16") | <2005 | W7 | W7 | |
| Ducato (wheel 15") | 2006> | W31 | W31 | |
| Ducato (wheel 16") | 2006> | W41 | W41 | |
| Freemont | - | HA | HA | |
| 500L | 11/2012> | A1 | A1 | |
| FORD | | | | |
| Sierra, Scorpio, Granada, Consul, Mondeo, Puma, Cougar, Fusion, Focus, Focus Multispazio, C-Max, Fiesta, Escort, Orion, Kuga | - | HA | T2 | |
| Probe | - | - | H1 | |
| Explorer | - | - | TE | |
| Maverick | - | RA | T7 | T7 |
| S-Max | 06/2006> | AD1 | AD1 | |
| Galaxy | <08/2006 | AL3 | AL3 | |
| Galaxy | 09/2006> | AD1 | AD1 | |
| Ranger 4x4 | 07/2007> | HA1 | HA1 | |
| Ka | <12/2008 | HA | T2 | |
| Ka | 01/2009> | A1 | A1 | |
| Kuga, Focus, C-Max, Fiesta, Kuga, B-Max | 01/2014> | H | H | |
| GREAT WALL MOTORS | | | | |
| Hover, Steed | 2010> | RA | RA | |
| HONDA | | | | |
| Jazz, Civic, HR-V, CR-V, FR-V | - | CA | CA | |
| Legend | - | V4 | 392 | |
| S2000 | 10/2007> | - | AC1 | |
| Accord | <05/2008 | AC1 | AC1 | |
| Accord | 06/2008> | CA | CA | |
| CR-Z, Insight | | CA | CA | |
| HYUNDAI | | | | |
| X2 Pony, Lantra, Stellar, Tucson | - | HA1 | HA1 | |
| Sonata, Matrix, Elantra | - | H1 | H1 | |

| | | | | |
|---------------------------|---------------------|------|------|----|
| Atos | - | DC1 | DC1 | |
| XG | 2000> | DC1 | DC1 | |
| Accent | <2001 | H1 | H1 | |
| Coupè | <2001 | HA1 | HA1 | |
| Coupè, Accent | 2002> | DC1 | DC1 | |
| Getz Fun | - | HH | - | |
| Starex | - | HH1 | - | |
| Galloper | - | H1 | 282 | |
| Terracan | - | - | 382 | |
| Trajet | <2000 | HA1 | HA1 | |
| Trajet GSI 2.7 | 2000-2004 | - | 382 | |
| H-1 | - | DC6 | - | |
| Santa Fe | <04/2006 | HA1 | HA1 | |
| Santa Fe | 05/2006- 12/2010 | H1 | H1 | |
| Santa Fe | 01/2011> | N.D. | N.D. | |
| Sonica | <06/2006 | HA1 | DC1 | |
| Sonica | 07/2006> | H1 | H1 | |
| i10 | 04/2008> | H1 | H1 | |
| i20, iX20 | 02/2009> | HA1 | HA1 | |
| i40 | 07/2011> | HA1 | HA1 | |
| i30 | 09/2007> | H1 | H1 | |
| iX35, ix55 | | H1 | H1 | |
| Veloster | 10/2011> | HA1 | HA1 | |
| INNOCENTI | | | | |
| Koral, Elba | - | A | - | |
| ISUZU | | | | |
| Piazza, Turbo | - | H | H | |
| D-Max | - | HA | HA | |
| Trooper Pick up | - | 490 | HA | HA |
| JAGUAR | | | | |
| X Type, S Type | 02/2004> | DC3 | 462 | |
| XJ, XK, XF | - | - | 462 | |
| JEEP | | | | |
| Cherokee, Wrangler | | AE | AE | AE |
| Renegade | | R | R | |
| Commander | 05/2006> | - | AE | |
| Compass | 03/2007> | HA | HA | |
| Patriot | 11/2007> | HA | HA | |
| Gran Cherokee | <12/2010 | AE | AE | AE |
| Gran Cherokee | 01/2011> | - | DC6 | |
| KIA MOTORS | | | | |
| Pride | - | I3 | I3 | |
| Clarus, Picanto, Cerato - | - | H1 | H1 | |
| Sorento | 2002> | HA1 | HA1 | |
| Carens | 2001> | HA1 | HA1 | |
| Shuma | <2000 | - | H | |
| Shuma II | 2001> | DC1 | DC1 | |
| Carnival | - | - | H | |
| Rio | <2005 | L2 | - | |
| Rio | 2006> | HA1 | HA1 | |
| Magentis | <07/2006 | DC1 | DC1 | |
| Magentis | 08/2006> | H1 | H1 | |
| Cee'd | 03/2007> | HA1 | HA1 | |
| Opirus | 11/2006> | - | 382 | |
| Pro-Cee'd | 01/2008> | H1 | H1 | |
| Venga, Soul | 10/2008> | HA1 | HA1 | |
| Sportage, Mentor | <2004 | HA1 | HA1 | |

|  Modelle Models Модель | Jahr Year Год | Stahlfelgen Steel Wheels Стальные Диски | Original Alufelgen Original Alloy Wheels Оригинальные Алюминиевые Диски | Ersatzreifen Spare Tire Запасные Колеса | |
|--|--|--|--|--|--|
| | | | | | |
| Sportage | 2005> | H1 | H1 | | |
| LADA | | | | | |
| Riva, Samara | - | G | E1 | | |
| Niva | - | RA | R | | |
| Kalina, Priora | | K | K | | |
| LANCIA | | | | | |
| Dedra | - | G | E1 | | |
| Z | - | W3 | W3 | | |
| Lybra, Thesis | - | A1 | A1 | | |
| K | <1998 | A | SH | | |
| K | 1999> | A1 | A1 | | |
| Phedra | <2002 | W2 | W3 | | |
| Phedra | 2003> | C1 | C2 | | |
| Y | <2000 | G | E1 | | |
| Y | 2001> | A1 | A1 | | |
| Ypsilon, Musa, Linea | 2003> | A1 | A1 | | |
| Delta | 2008> | A1 | A1 | | |
| Thema | 11/2011> | DC6 | DC6 | | |
| Voyager | 11/2011> | HA | HA | | |
| Flavia | 2012> | HA | HA | | |
| LAND ROVER | | | | | |
| Range Rover | <1995 | AG | AG1 | | |
| Range Rover | 1996-2001 | - | AG2 | | |
| Range Rover (wheel 18") | 2002-2005 | - | N.D. | | |
| Range Rover (wheel 20") | 2002-2005 | - | N.D. | | |
| Range Rover | 09/2005> | - | N.D. | | |
| Discovery | 1988-1999 | AG | AG1 | AG1 | |
| Discovery | 2000-2005 | - | AG2 | AG2 | |
| Discovery 3, Range Rover Sport Discovery 4 | 01/2005> | - | N.D. | | |
| Defender - | - | AG | AG1 | AG1 | |
| Freelander | <2006 | CA2 | AG3 | AG3 | |
| Freelander | 2007-09/2010 | HB | HB | | |
| Freelander 2 | 10-2010> | - | H | | |
| Range Rover Evoque | 10/2011> | AD1 | AD1 | | |
| LEXUS | | | | | |
| GS 300 | 1993-2000 | HA1 | 282 | | |
| GS 300/420 | 2000> | HA1 | 382 | | |
| LS | <1995 | HA1 | 282 | | |
| LS | 1995> | HA1 | HL | | |
| IS | 1999> | HA1 | 382 | | |
| RX | 2003> | HA1 | 382 | | |
| SC430 | 11/2000> | - | 482 | | |
| GS450 | 06/2006> | - | 482 | | |
| LS460 | 01/2007> | - | N.D. | | |
| CT200h, HS250h | | H1 | 282 | | |
| LOTUS | | | | | |
| Esprit III, S3, Eclat XL | - | H | H | | |
| Esprit 2.2 Turbo SE | 1989> | - | W2 | | |

| | | | | | |
|--|-----------|-----|-----|-----|--|
| Elise, Exige | 2002> | - | I | | |
| Europa S | 09/2006> | - | I | | |
| MAHINDRA | | | | | |
| Goa, Bolero | - | V3 | - | | |
| Goa Pick-up, Bolero Pik-up | - | - | HB | | |
| MAZDA | | | | | |
| 323 | <1996 | H1 | H1 | | |
| 323 | 1997> | HA1 | HA1 | | |
| 929, 626, RX7, demio, Premacy | - | H1 | H1 | | |
| 121 | 1996> | HA | T2 | | |
| Tribute - | - | HA | H | | |
| 3MPS | | H | H | | |
| Mazda 2 | 2003> | HA | T2 | | |
| MX3, MX-5, MX6, Xedos 6, Xedos 9, MPV, RX8, Mazda 6, Mazda 3, Mazda 5, CX-7, BT-50 | - | HA1 | HA1 | | |
| CX-5 | 09/2011> | HA1 | HA1 | | |
| MERCEDES | | | | | |
| Classe A (*169, *245) | <2004 | - | ZA | | |
| Classe A Avantgarde | <2004 | - | SGK | | |
| Classe A (escluso, except, Classe A, *169-*245, Avantgarde) | <05/2005 | L | SG | | |
| Classe A | 06/2005> | ZA | ZA | | |
| Classe B | 06/2005> | ZA | ZA | | |
| Classe C | <03/2007 | L | SG | | |
| Classe C | 04/2007> | ZA | ZA | | |
| Classe CL | - | - | Z4 | | |
| CLK | - | - | SG | | |
| CLS | 11/2004> | - | ZA | | |
| Classe E (*124,*210) | <2004 | L | SG | | |
| Classe E (*211) | <2004 | - | ZA | | |
| Classe E Avantgarde | <2004 | - | SGK | | |
| Classe E | 2005> | - | ZA | | |
| Classe G | <1985 | AL1 | AL1 | AL1 | |
| Classe G | 1986-2004 | AL3 | AL5 | AL5 | |
| Classe G | 01/2005> | - | Z4 | | |
| Classe M | - | - | ZA | | |
| Classe R | - | - | ZA | | |
| Classe S | <2000 | L | SG | | |
| Classe S | 2001> | - | Z4 | | |
| SE 140 | - | Z | - | | |
| SE 140 (wheel with 8 holes) | - | - | SGK | | |
| SE 140 (wheel with 15 holes) | - | - | Z4 | | |
| SLK | <2004 | L | SG | | |
| SLK | 2005> | ZA | ZA | | |
| SLR | - | - | Z4 | | |
| Classe V | - | AL | AL | | |
| Vaneo | - | L | L | | |
| Viano | - | AL1 | AL6 | | |
| Vito | <01/2004 | AL1 | AL6 | | |
| Vito | 02/2004> | ZA | ZA | | |
| SL (*129) | <04/2006 | L | SG | | |
| SL (*230) | <04/2006 | - | ZA | | |
| SL | 05/2006> | - | ZA | | |
| GL | 06/2006> | - | Z4 | | |
| Sprinter | 04/2007> | AL3 | AL6 | | |
| GLK | 04/2009> | - | Z4 | | |
| CLC | 05/2008> | ZA | ZA | | |

|  Modelle Models Модель | Jahr Year Год | Stahlfelgen Steel Wheels Стальные Диски | Original Alufelgen Original Alloy Wheels Оригинальные Алюминиевые Диски | Ersatzreifen Spare Tire Запасные Колеса |
|--|--|--|--|--|
| | | | | |
| Citan | 2013> | I3 | I3 | |
| MG | | | | |
| ZR, ZS, ZT | - | 369 | 369 | |
| TF | - | 680 | 680 | |
| MGF | - | - | 680 | |
| MINI | | | | |
| Mini | <10/2006 | I | I | |
| Mini, Mini station, Mini coupè, Mini Spider, Mini Countryman, Mini Paceman | 11/2006> | N.D. | N.D. | |
| MITSUBISHI | | | | |
| Starion, Tredia, Cordia, Space Wagon, Carisma | - | H1 | H1 | |
| Space Star | - | DC1 | DC1 | |
| Sigma | 1989> | H1 | 282 | |
| Shogun | 1991> | 282 | 282 | 282 |
| Montero | <1991 | H1 | H1 | |
| Montero | 1997> | 282 | 282 | |
| Galant | 1993> | 282 | 282 | |
| Eclipse | - | - | 382 | |
| Lancer | <2002 | H1 | H1 | |
| Lancer | 2003> | HA1 | HA1 | |
| Lancer Evolution | <09/2008 | - | 482 | |
| Lancer Sport Sedan | 2008> | - | 382 | |
| L200 | - | H1 | 282 | |
| Pajero | <1991 | H1 | H1 | |
| Pajero | 1992-02/2007 | 282 | 282 | |
| Pajero Pinin | - | HA1 | 382 | |
| Pajero | 03/2007> | - | 482 | |
| Pajero ,09 Limited Edition | 02/2009> | - | 382 | VH4 |
| Grandis | 11/2005> | - | 482 | |
| Outlander, Outlander Sport | <02/2007 | - | 482 | |
| Outlander | 03/2007-09/2010 | DC1 | 482 | |
| Lancer Evolution | 10/2008> | - | 382 | |
| Colt | <01/2009 | H1 | H1 | |
| Colt | 02/2009> | DC1 | DC1 | |
| ASX, Outlander | 10/2010> | H1 | 382 | |
| NISSAN | | | | |
| Stanza, Cherry, Pulsar, Cedric, Sunny, Violet, Auster, Bluebird, Laurel, Silvia - | - | R1 | R1 | |
| QX | - | - | R1 | |
| Maxima, Patrol, Primera, 200 SX 300 ZX, 100 NX, Serena, 280 ZX, Almera - | - | R1 | RA1 | |
| Almera Tino Multispazio - | - | DC2 | RA1 | |

| | | | | |
|---|-----------------|------|------|----|
| Terrano | - | RA1 | RA1 | |
| Murano, Pathfinder, X-Trail, Navara Pick-up | - | - | RA1 | |
| 350Z | - | - | R1 | |
| Micra | <12/2003 | R1 | R1 | |
| Micra | 01/2004-10/2010 | P | P | |
| Micra | 11/2010> | RA1 | RA1 | |
| Note | 2004> | P | P | |
| 370Z, Cube, elettrica EV, elettrica Leaf, NV200, Tiida, Pixo, Juke | | RA1 | RA1 | |
| OPEL | | | | |
| Omega, Vectra, Calibra, Tigra, Signum, Meriva, Combo, Tigra Twin Top, Corsa, GT | 1989> | I3 | I3 | |
| Agila | <09/2003 | DC4 | DC4 | |
| Agila | 10/2003> | I3 | I3 | |
| Speedster | - | - | I | |
| Frontera | - | 490R | HA | HA |
| Monterey | - | 490R | HA | |
| Vivaro | - | W3 | - | |
| Antara | 06/2006> | H | H | |
| Astra | 1989-11/2009 | I3 | I3 | |
| Astra | 12/2009> | H | H | |
| Insigna | - | DC6 | DC6 | |
| Zafira | 1989-12/2011 | I3 | I3 | |
| Zafira Tourer | 01/2012> | H | H | |
| Mokka | 2012> | H | H | |
| Adam | 2013> | I3 | I3 | |
| PEUGEOT | | | | |
| 305 (except alloy wheels 1.6) | 1986> | A | AH1 | |
| 605 (except alloy wheels SV24) | 1995> | A | AH1 | |
| 206 1.6 GTI, 205 1.6 GTI, 309 GT, 406 1.6 GTI, 106 1.6 GTI, 305 1.6 | <2000 | - | AH2 | |
| 405 (except T16) | <2000 | A | AH1 | |
| 106 (eccetto, except 1.6 GTI) | <2000 | A | AH1 | |
| 306 (eccetto, except XSI, S16 cab, J 2000) | <2000 | A | AH1 | |
| 309 (eccetto, except GT) | <2000 | A | AH1 | |
| 406 (eccetto, except 1.6 GTI) | <2000 | A | AH1 | |
| 205 (eccetto, except 1.6 GTI) | <2000 | A | AH1 | |
| 206 (eccetto, except 1.6 GTI) | <2000 | A | AH1 | |
| 607 | <2002 | - | AH4 | |
| 806 | - | W2 | W2 | |
| 807 | - | C1 | C2 | |
| 106, 206, 306, 406, 607, 307, Ranch | 2001-2002 | A | AH4 | |
| 106, 206, 307, 406, 607, 1007, 407, 407 SW, Ranch, 207, Expert Tepee, 308, Bipper, Partner, 508, 3008, 5008 | 2003> | K | ZH4 | |
| 107 | - | I3 | N.D. | |
| 4007 | 02/2008> | - | 382 | |
| Boxer (wheel 15") | 06/2007> | W31 | W31 | |
| Boxer (wheel 16") | 06/2007> | W41 | W41 | |
| RCZ | | ZH4 | ZH4 | |
| PORSCHE | | | | |
| 914/4, 924 (wheel 14") | <1985 | Z | Z | |
| 912, 928, 944 | - | - | V | |
| Carrera | - | - | AD | |



Modelle
Models
Модель

| Modelle Models Модель | Jahr Year Год | Stahlfelgen Steel Wheels Стальные Диски | Original Alufelgen Original Alloy Wheels Оригинальные Алюминиевые Диски | Ersatzreifen Spare Tire Запасные Колеса |
|--|---------------------|---|---|---|
| 911 | 1987-1998 | - | AD | |
| 911 | 1999> | - | AL1 | |
| 924 Turbo | - | - | Z5 | |
| 968 | - | - | AL3 | |
| Boxter | 1996> | - | AL1 | |
| Cayman | - | - | N.D. | |
| Cayenne | - | - | AL3R | |
| RENAULT | | | | |
| All models wheel 4 holes | <08/2005 | P | P | |
| All models wheel 4 holes | 09/2005> | I | I | |
| All models wheel 5 holes | <08/2005 | W2 | W3 | |
| All models wheel 5 holes | 09/2005> | C1 | C2 | |
| Laguna II (wheel 5 holes) | <08/2005 | P | P | |
| Laguna II (wheel 5 holes) | 09/2005> | I | I | |
| Laguna | 2007> | C1 | C2 | |
| Twingo | 2007> | I | I | |
| Clio(3 ^a 2005), Clio(4 ^a 2012) | 2006> | I | I | |
| Clio RS (3 ^a 2005) | 2006> | C1 | C2 | |
| Modus | 2006> | I | I | |
| Mégane | 2006> | I | I | |
| Megane RS | 2006> | C1 | C2 | |
| Kangoo, Grand Kangoo | 2006> | I | I | |
| Scénic (3 ^a serie, third series) | 2009> | I | I | |
| Espace (4 ^a serie, fourth series) | 2002> | C1 | C2 | |
| Master, Trafic | es 19 | C2 | - | |
| Koleos | 05/2008> | - | RA1 | |
| Fluence | 06/2009> | I | I | |
| Wind | 09/2010> | I | I | |
| Twizy | 2012 | - | I | |
| Latitude | 2008> | C1 | C2 | |
| Capture | 04/2013> | I | I | |
| ROVER | | | | |
| Metro | 1980-1990 | AF | 868 | |
| Metro | 1990-1995 | CA | 680 | |
| Mini R | 1988> | AF | 868 | |
| Maestro | 1983-1995 | HA | 680 | |
| Montego | 1984-1995 | HA | 680 | |
| 200 | 1984-1989 | CA | CA | |
| 400 | 1995> | CA | CA | |
| 200-400 | 1989-1995 | CA | 680 | |
| 200 | 1996> | CA | CA | |
| 75 | - | C1 | C1 | |
| 100, 111 | - | CA | 680 | |
| 600, 25, 45 | - | CA | CA | |
| 800 | - | HA | 680 | |
| Streetwise | - | - | 369 | |
| SAAB | | | | |
| 99 | - | AE | AE | |

| | | | | |
|--|-----------|-----|-----|----|
| 900 | <1988 | AE | AE | |
| 900 | 1988-1993 | W2 | W2 | |
| 900 | 1993> | I3 | I3 | |
| 9000 | - | W2 | W2 | |
| 9-3 | - | I3 | I3 | |
| 9-5 | <2010 | I3 | I3 | |
| 9-5 | 2010> | - | DC6 | |
| SEAT | | | | |
| All models wheel 4 holes | - | L2 | L2 | |
| All models wheel 5 holes (excepto, except Alhambra) | - | ZA | ZA | |
| Ibiza, Leon, Exeo, Altea, Altea XL, Leon 2013, Toledo 2013 | | ZA | ZA | |
| Alhambra | - | AL3 | AL3 | |
| Mii | 2011> | - | - | |
| SKODA | | | | |
| All models wheel 4 holes | - | L2 | L2 | |
| All models wheel 5 holes | - | ZA | ZA | |
| Fabia, Octavia, Superb, Roomster, Yeti, Rapid | | ZA | ZA | |
| Citigo | 09/2012> | - | - | |
| SMART | | | | |
| Fortwo | - | L2 | L2 | |
| Forfour | 04/2004> | - | HA1 | |
| SSANGYONG | | | | |
| Musso | - | HA1 | HA1 | |
| Rodius | - | ZA | ZA | |
| Rexton | <2002 | - | H1 | |
| Rexton Premium, Kyron | 2003> | HB | HB | |
| Rexton Plus TOD | 2003> | HA1 | HA1 | |
| Rexton II | 07/2006> | - | HB | |
| Actyon | 01/2007> | HB | HB | |
| Korando | 2002>2009 | H1 | H1 | |
| Korando | 2010> | M | M | |
| SUBARU | | | | |
| Leone, Justy, Legacy, XT, SVZ, Forester | - | RA | RA | |
| Vivio | - | R | R | |
| Outback | - | - | RA | |
| B9 Tribeca | - | - | DC5 | |
| Impreza | <08/2007 | R | R | |
| Impreza | 09/2007> | RA | RA | |
| WRX, XV | | RA | RA | |
| Trezia, BRZ | 05/2011> | HA1 | 382 | |
| SUZUKI | | | | |
| Carry, Escudo, LJ 80, SJ 410, 413, X 90, Capuccino, Liana, Gran Vitara, Swift 4x4 | - | RA | RA | |
| Vitara, Samurai, Jimny | - | RA | RA | RA |
| Wagon R+ | - | DC5 | DC5 | |
| Baleno | - | DC5 | R | |
| Swift | <04/2005 | RA | RA | |
| Swift, SX4, Splash | 05/2005> | I3 | I3 | |
| Ignis | <2002 | DC5 | DC5 | |
| Ignis | 2003> | I3 | I3 | |
| Alto | <02/2009 | RA | RA | |
| Alto | 03/2009> | DC5 | DC5 | |
| TATA | | | | |
| Pick-up Tata TL, Telco | | V2 | - | |
| Safari | <2004 | V2 | - | |



Modelle
Models
Модель

| Modelle Models Модель | Jahr Year Год | Stahlfelgen Steel Wheels Стальные Диски | Original Alufelgen Original Alloy Wheels Оригинальные Алюминиевые Диски | Ersatzreifen Spare Tire Запасные Колеса |
|--|---------------------|---|---|---|
| Safari, Xenon, Crossover | 2005> | - | V | |
| Indigo, Indica | <2005 | P1 | P1 | |
| Indica | 2006> | HA2 | HA2 | |
| Aria | | V | V | |
| TOYOTA | | | | |
| 4 Runner | 1990> | HA1 | 282 | |
| Avensis | <2002 | HA1 | 482 | |
| Avensis | 2003> | HA1 | 382 | |
| Camry | 1996> | HA1 | HA1 | |
| Carina | 1982-1987 | H1 | 282 | |
| Carina II | 1988-1992 | HA1 | 482 | |
| Carina E (no GTI) | 1992-1998 | HA1 | HA1 | |
| Carina E GTI | 1992-1997 | HA1 | 482 | |
| Celica GT/GT4 | 1992-1998 | HA1 | 482 | |
| Celica | 1989> | HA1 | 282 | |
| Corolla (no GTI) | 1987-1992 | H1 | 282 | |
| Corolla GTI | 1987-1992 | HA1 | 482 | |
| Corolla | 1992-1997 | HA1 | 282 | |
| Corolla | 1997> | H1 | 482 | |
| Corolla Verso | 2007> | HA1 | 382 | |
| MR2 | 1984-1989 | HA1 | 282 | |
| MR2 | 1990> | HA1 | 482 | |
| Paseo | 1996> | HA1 | HA1 | |
| Previa | 1989> | HA1 | 282 | |
| Picnic | 1996> | HA1 | HA1 | |
| Space Cruiser | 1986-1993 | HA1 | 282 | |
| Starlet | 1978-1997 | H1 | 282 | |
| Starlet | 1997-1999 | H1 | H1 | |
| Yaris | 1999> | HA1 | 382 | |
| Prius | 04/2004> | HA1 | 382 | |
| Aygo | 2005> | I3 | N.D. | |
| Land Cruiser Tipo J8 | 1982-1989 | H1 | H1 | H1 |
| Land Cruiser Tipo J9 - | | - | 482 | 482 |
| Land Cruiser J10, HDJ100, LC100 - | | AD1 | N.D. | |
| Land Cruiser V8 | 03/2008> | - | N.D. | |
| Land Cruiser | 01/2011> | - | 482 | |
| Hilux - | | 382 | 382 | |
| Rav4 (5 doors, portiéres, Tür) | <2003 | HA1 | 482 | |
| Rav4 (3 doors, portiéres, Tür) | <2003 | H1 | - | |
| Rav4 | 2004> | HA1 | 382 | |
| Auris | 04/2007> | HA1 | 382 | |
| IQ | 02/2009> | HA1 | 382 | |
| Urban Cruiser, Verso | | HA1 | HA1 | |
| Verso s | | - | 382 | |
| TRIUMPH | | | | |
| TR4, 5, 6, 2300, STAG, 2000 | - | S | 772 | |
| Herald, Vitesse, GT6, Spitfi re, Toledo, Dolomite, Sprint | - | AF | 168 | |
| Acclaim, TR7, TR8 | - | H | - | |

| | | | | |
|--|----------|------|------|--|
| TVR | | | | |
| 2500, 3000 | - | S | S | |
| Tasmin 2.8, 350i, 390 SE, 400, 450, SEAC, 3.9 & 4.3 Speed Eight, Griffith, Chimaera | - | H | H | |
| UAZ | | | | |
| All models | - | AD1 | AD1 | |
| VOLKSWAGEN | | | | |
| All models wheel 4 holes | - | L2 | L2 | |
| All models wheel 5 holes | - | ZA | ZA | |
| Sharan | - | N.D. | N.D. | |
| Touran | <2006 | AL3 | AL3 | |
| Touran | 2007> | ZA | ZA | |
| Touareg, Amarok | - | - | N.D. | |
| Transporter | 2009 | N.D. | - | |
| Lupo | - | L2 | L2 | |
| up! | 09/2011> | - | - | |
| Golf, Golf Station, Golf Multispazio, Passat, Jetta, Phanteon, Scirocco, Eos, Polo, Fox, Tiguan, Maggolino | 01/2000> | ZA | ZA | |
| VOLVO | | | | |
| 120, 140, 160, P 1800, 240, 244, 245, 260, 265 | | AE | AE | |
| 340, 343, 345, 360 | | R | R | |
| 440, 460, 480 ES, 445 | | K | K | |
| 740, 760, 780, 940, 960, S90, V90 | | HA | HA | |
| V50, S40, V40 | | H | H | |
| S80, V80 | | W3 | W3 | |
| 850, S70, V70, S60, V60 | <2002 | J1 | J2 | |
| S60, V70 | 2003> | W3 | W3 | |
| C70 | <01/2006 | J1 | J2 | |
| C70 | 02/2006> | HA | HA | |
| XC70, XC90 | 12/2005> | - | W3 | |
| C30 | 11/2006> | HA | HA | |
| XC60 | 11/2008> | W3 | W3 | |
| V60, S80 | 09/2010> | W3 | W3 | |
| V40 Cross Country | Nov-12 | HA | HA | |
| WARTBURG | | | | |
| Trabant, Sedan, Tourist | - | HA | - | |
| ZASTAVA | | | | |
| Yugo 45, 55, 311, 511, GV, GVL, GVX | - | E1 | E1 | |
| ACHTUNG / NOTE N.D. = NICHT VERFÜGBAR NOT AVAILABLE ITEMS | | | | |

ist eine eingetragene Marke
der HEYNER GMBH, Deutschland.

Logistik und Dienstleistungen für die
automotive Industrie.
alca mobil logistics + services gmbh
Kurzer Weg 1-5 D-15859 Storkow
Tel. +49 (0) 33678 687-0
Fax: +49 (0) 33678 61044
www.alcamobil.de



Bolzen 60°
Bolt 60°



| REF. | ES. | M | L | R |
|------|-----|----------|----|---|
| C1 | 17 | M14X1,5 | 25 | |
| C2 | 17 | M14X1,5 | 29 | |
| C3 | 17 | M14X1,5 | 35 | |
| C4 | 17 | M14X1,5 | 40 | |
| C5 | 17 | M14X1,5 | 45 | |
| 891A | 17 | M14X1,5 | 64 | |
| 791 | 19 | M14X1,5 | 20 | |
| W2 | 19 | M14X1,5 | 25 | |
| W3 | 19 | M14X1,5 | 29 | |
| W8 | 19 | M14X1,5 | 35 | |
| W5 | 19 | M14X1,5 | 40 | |
| W31 | 21 | M14X1,5 | 29 | |
| W1 | 24 | M14X1,5 | 29 | |
| W6 | 24 | M14X1,5 | 34 | |
| N1 | 17 | M14x1,25 | 28 | |
| W4 | 24 | M16X1,5 | 32 | |
| W7 | 24 | M16X1,5 | 34 | |
| W41 | 21 | M16X1,5 | 32 | |
| J1 | 19 | M12X1,75 | 25 | |
| J2 | 19 | M12X1,75 | 28 | |
| A1 | 17 | M12X1,25 | 22 | |
| K | 17 | M12X1,25 | 25 | |
| E4 | 17 | M12X1,25 | 31 | |
| E3 | 17 | M12X1,25 | 35 | |
| SH3 | 17 | M12X1,25 | 40 | |
| SH4 | 17 | M12X1,25 | 45 | |
| SH5 | 17 | M12X1,25 | 50 | |
| G | 19 | M12X1,25 | 22 | |
| A | 19 | M12X1,25 | 25 | |
| E2 | 19 | M12X1,25 | 29 | |
| E1 | 19 | M12X1,25 | 31 | |
| E | 19 | M12X1,25 | 35 | |
| SH | 19 | M12X1,25 | 40 | |
| SH1 | 19 | M12X1,25 | 45 | |
| SH2 | 19 | M12X1,25 | 50 | |
| I2 | 17 | M12X1,5 | 20 | |
| I3 | 17 | M12X1,5 | 23 | |
| I | 17 | M12X1,5 | 26 | |
| I4 | 17 | M12X1,5 | 28 | |
| I1 | 17 | M12X1,5 | 30 | |
| SA1 | 17 | M12X1,5 | 35 | |
| SA | 17 | M12X1,5 | 40 | |
| SA2 | 17 | M12X1,5 | 45 | |
| SA3 | 17 | M12X1,5 | 50 | |
| 483 | 17 | M12X1,5 | 45 | |
| 583 | 17 | M12X1,5 | 58 | |
| 387 | 19 | M12X1,5 | 20 | |
| P1 | 19 | M12X1,5 | 23 | |
| P | 19 | M12X1,5 | 26 | |
| P2 | 19 | M12X1,5 | 30 | |
| P3 | 19 | M12X1,5 | 35 | |
| SF | 19 | M12X1,5 | 40 | |
| PP1 | 21 | M12X1,5 | 20 | |

Bolzen, abgefasst
Radius bolt



| REF. | ES. | M | L | R |
|------|-----|---------|----|----|
| Z | 17 | M14X1,5 | 25 | 13 |
| ZA | 17 | M14X1,5 | 27 | 13 |
| Z2 | 17 | M14X1,5 | 35 | 13 |
| Z3 | 17 | M14X1,5 | 40 | 13 |
| Z4 | 17 | M14X1,5 | 45 | 13 |

| | | | | |
|---------|----|----------|----|----|
| Z5 | 17 | M14X1,5 | 70 | 13 |
| 691 | 19 | M14X1,5 | 20 | 13 |
| AL | 19 | M14X1,5 | 25 | 13 |
| AL1 | 19 | M14X1,5 | 27 | 13 |
| AL3 | 19 | M14X1,5 | 35 | 13 |
| AL4 | 19 | M14X1,5 | 40 | 13 |
| AL5 | 19 | M14X1,5 | 45 | 13 |
| AL6 | 19 | M14X1,5 | 52 | 13 |
| L | 17 | M12X1,5 | 20 | 12 |
| L2 | 17 | M12X1,5 | 24 | 12 |
| M | 17 | M12X1,5 | 28 | 12 |
| SG1 | 17 | M12X1,5 | 35 | 12 |
| SG | 17 | M12X1,5 | 40 | 12 |
| SG2 | 17 | M12X1,5 | 45 | 12 |
| AHD | 19 | M12X1,5 | 28 | 12 |
| SG3 | 19 | M12X1,5 | 40 | 12 |
| ALKO 10 | 19 | M10X1,25 | 22 | 12 |

Bolzen mit sphärische Unterlegscheibe
Bolt with spheric washer



| REF. | ES. | M | L | R |
|--------|-----|---------|----|----|
| AL3/R | 19 | M14X1,5 | 36 | 14 |
| WP14/A | 17 | M14x1,5 | 28 | 13 |
| PP13/A | 17 | M14x1,5 | 29 | 14 |

Bolzen, konisch oder abgefasst mit verlängertem Kopf
Conical or radius bolt with long head



| REF. | ES. | M | L | A | SEITE |
|------|-----|---------|----|----|-------|
| SGX | 17 | M12X1,5 | 40 | 92 | 12 |
| SGY | 17 | M12X1,5 | 30 | 68 | 12 |
| SGZ | 17 | M12X1,5 | 40 | 75 | 12 |
| SGQ | 17 | M12X1,5 | 28 | 72 | 60° |
| SGW | 17 | M12X1,5 | 40 | 75 | 60° |
| SGK | 17 | M14X1,5 | 45 | 85 | 13 |

Bolzen-Abstandsänderung
Bolt inner-axe variation



| REF. | ES. | M | L |
|------|-----|----------|----|
| A10 | 17 | M12X1,25 | 27 |
| A5 | 17 | M12X1,25 | 30 |
| A9 | 17 | M12X1,25 | 34 |
| A4 | 19 | M12X1,25 | 30 |
| A8 | 19 | M12X1,25 | 34 |
| A11 | 19 | M12X1,25 | 27 |
| A6 | 17 | M12X1,5 | 30 |
| A7 | 19 | M12X1,5 | 30 |

Bolzen, flach mit Durchmesser
Flat bolt with diameter



| REF. | ES. | M | ø | L | A |
|------|-----|----------|------|----|----|
| ZH4 | 17 | M12X1,25 | 17 | 36 | 63 |
| AH4 | 19 | M12X1,25 | 17 | 36 | 63 |
| VH4 | 21 | M12X1,25 | 17 | 36 | 63 |
| AH6 | 17 | M12X1,5 | 18,5 | 33 | 53 |

Bolzen, flach mit Unterlegscheibe
Flat bolt with washer



| REF. | ES. | M | L | A |
|------|-----|----------|----|----|
| ZH1 | 17 | M12X1,25 | 35 | 61 |
| ZH2 | 17 | M12X1,25 | 35 | 68 |
| ZH3 | 17 | M12X1,25 | 38 | 87 |
| AH1 | 19 | M12X1,25 | 35 | 61 |
| AH2 | 19 | M12X1,25 | 35 | 68 |
| AH3 | 19 | M12X1,25 | 38 | 87 |
| AH | 19 | M12X1,25 | 43 | 69 |
| AH5 | 19 | M12X1,25 | 67 | 86 |

Mutter 60°
Nut 60°



| REF. | ES. | M | F | L |
|------|-----|-----------|----|----|
| HA2 | 17 | M12X1,5 | 21 | 30 |
| DC3 | 19 | M12X1,5 | 21 | 21 |
| H | 19 | M12X1,5 | 26 | 34 |
| HA | 19 | M12X1,5 | 21 | 30 |
| 170 | 19 | M12X1,5 | 26 | 34 |
| 490R | 19 | M12X1,5 | 25 | 38 |
| DC1 | 21 | M12X1,5 | 21 | 21 |
| H1 | 21 | M12X1,5 | 26 | 34 |
| HL | 21 | M12X1,5 | 32 | 48 |
| HA1 | 21 | M12X1,5 | 21 | 30 |
| H2 | 22 | M12X1,5 | 26 | 34 |
| DC4 | 17 | M12X1,25 | 21 | 21 |
| RA2 | 17 | M12X1,25 | 21 | 30 |
| DC5 | 19 | M12X1,25 | 21 | 21 |
| R | 19 | M12X1,25 | 26 | 34 |
| RA | 19 | M12X1,25 | 21 | 30 |
| DC2 | 21 | M12X1,25 | 21 | 21 |
| R1 | 21 | M12X1,25 | 26 | 34 |
| RA1 | 21 | M12X1,25 | 21 | 30 |
| AEH | 19 | 1/2" UNF | 27 | 27 |
| AE | 19 | 1/2" UNF | 24 | 34 |
| AE2 | 21 | 1/2" UNF | 24 | 34 |
| AE1 | 22 | 1/2" UNF | 24 | 34 |
| AD | 19 | M14X1,5 | 26 | 34 |
| HB | 21 | M14X1,5 | 26 | 26 |
| AD1 | 21 | M14X1,5 | 26 | 34 |
| 192A | 22 | M14X1,5 | 27 | 34 |
| DC6 | 22 | M14X1,5 | 26 | 26 |
| AG | 27 | M16X1,5 | 31 | 31 |
| S | 19 | 7/16" UNF | 26 | 34 |
| QA | 19 | M10x1,25 | 22 | 30 |
| Q | 17 | M10x1,25 | 22 | 30 |
| AF | 17 | 3/8" UNF | 22 | 30 |
| Q1 | 17 | M10x1,5 | 22 | 30 |

Mutter konisch + zylindrisch zu 60°
Conical nut + cylindrical 60°



| REF. | ES. | M | ø | L | F |
|-------|-----|----------|------|------|----|
| T91 | 19 | M12X1,25 | 15,5 | 5 | 33 |
| T7 | 19 | M12X1,25 | 16 | 7 | 27 |
| T9 | 19 | M12X1,25 | 18 | 12,5 | 30 |
| 979 | 19 | M12X1,25 | 17,5 | 28 | 32 |
| T71 | 21 | M12X1,25 | 16 | 7 | 27 |
| 076 | 19 | M12X1,5 | 16 | 12,5 | 27 |
| T6 | 19 | M12X1,5 | 16 | 7 | 27 |
| T61 | 21 | M12X1,5 | 16 | 7 | 27 |
| 682 | 21 | M12X1,5 | 17,7 | 33 | 36 |
| 476 | 21 | M12X1,5 | 17,5 | 7 | 26 |
| 576 | 21 | M12X1,5 | 17,5 | 28 | 32 |
| 690 B | 21 | M12X1,5 | 17,5 | 16 | 34 |
| 389 A | 19 | 1/2" UNF | 17 | 12 | 29 |

Mutter 60° mit Unterlegscheibe
Nut 60° with washer



| REF. | ES. | M | F | L |
|------|-----|----------|----|----|
| 280 | 19 | M12X1,5 | 22 | 30 |
| T2 | 19 | M12X1,5 | 27 | 27 |
| T1 | 19 | M12X1,25 | 27 | 27 |

Mutter, abgefasst
Radius nut



| REF. | ES. | M | F | L | R |
|------|-----|----------|----|----|----|
| AC | 19 | M12X1,25 | 22 | 30 | 12 |

| | | | | | |
|-----|----|----------|----|----|----|
| CA | 19 | M12X1,5 | 25 | 25 | 12 |
| AC1 | 19 | M12X1,5 | 22 | 30 | 12 |
| CA1 | 21 | M12X1,5 | 25 | 25 | 12 |
| CA2 | 22 | M12X1,5 | 25 | 25 | 12 |
| T | 17 | 3/8" UNF | 18 | 26 | 10 |
| V | 19 | M14X1,5 | 25 | 34 | 12 |
| V2 | 19 | M14X1,5 | 24 | 24 | 12 |
| V3 | 21 | M14X1,5 | 24 | 24 | 12 |
| V4 | 22 | M14X1,5 | 24 | 24 | 12 |

Mutter, abgefasst + konisch
Radius nut + conical

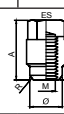

| REF. | ES. | M | ø | F | A |
|------|-----|---------------------|------|----|----|
| 689 | 21 | 1/2" UNF Dx - SX | 19,2 | 25 | 37 |
| AG3 | 22 | M12X1,5 | 21,5 | 26 | 34 |

Mutter, flach
Flat nut



| REF. | ES. | M | ø | L | F |
|-------|-----|-----------|------|----|----|
| AB | 19 | M12X1,25 | 19 | 3 | 17 |
| 179 | 19 | M12X1,25 | 17 | 13 | 27 |
| 279 | 21 | M12X1,25 | 17 | 13 | 27 |
| 379 | 21 | M12X1,25 | 19 | 13 | 27 |
| PA | 19 | M12X1,5 | 17 | 14 | 28 |
| 390 | 19 | M12X1,5 | 16 | 19 | 28 |
| 690 | 19 | M12X1,5 | 17,5 | 19 | 28 |
| 790 | 19 | M12X1,5 | 17,3 | 30 | 28 |
| 890 | 19 | M12X1,5 | 17,5 | 44 | 28 |
| 990 | 19 | M12X1,5 | 17,5 | 35 | 28 |
| 290 | 21 | M12X1,5 | 17 | 14 | 28 |
| 690 A | 21 | M12X1,5 | 17 | 19 | 30 |
| 990 A | 21 | M12X1,5 | 17 | 35 | 30 |
| 789 | 19 | 1/2" UNF | 17,5 | 19 | 27 |
| 889 | 19 | 1/2" UNF | 17,5 | 30 | 27 |
| 989 | 19 | 1/2" UNF | 17,5 | 44 | 27 |
| 489 | 21 | 1/2" UNF | 17,5 | 10 | 27 |
| 289 | 22 | 1/2" UNF | 17,5 | 10 | 27 |
| 168 | 17 | 3/8" UNF | 15 | 11 | 27 |
| 368 | 17 | 3/8" UNF | 14 | 19 | 35 |
| 468 | 17 | 3/8" UNF | 14 | 30 | 46 |
| 172 | 19 | 7/16" UNF | 16 | 19 | 28 |
| 272 | 19 | 7/16" UNF | 16 | 30 | 28 |
| 372 | 19 | 7/16" UNF | 16 | 44 | 28 |
| 472 | 19 | 7/16" UNF | 17,5 | 19 | 28 |
| 572 | 19 | 7/16" UNF | 17,5 | 30 | 28 |
| 672 | 19 | 7/16" UNF | 17,5 | 44 | 28 |
| 772 | 22 | 7/16" UNF | 19 | 13 | 28 |

Mutter, konisch mit Flachscheibe
Conical nut with flat washer



| REF. | ES. | M | ø | L | F |
|------|-----|-----------|------|------|----|
| 490 | 19 | M12X1,5 | 18 | 13 | 25 |
| F | 19 | M12X1,5 | 18,5 | 13 | 24 |
| 782 | 19 | M12X1,5 | 18,5 | 10 | 24 |
| 462 | 19 | M12X1,5 | 18,5 | 12 | 35 |
| 282 | 21 | M12X1,5 | 18,5 | 10 | 24 |
| 482 | 21 | M12X1,5 | 18,5 | 12 | 35 |
| 382 | 21 | M12X1,5 | 18,5 | 12 | 25 |
| AG6 | 21 | M14X1,5 | 22 | 12 | 38 |
| AG4 | 22 | M14X1,5 | 20 | 20 | 32 |
| 392 | 22 | M14X1,5 | 22 | 11,5 | 32 |
| AG7 | 22 | M14X1,5 | 22 | 12 | 38 |
| AG5 | 22 | M14X1,5 | 22 | 19 | 35 |
| AG2 | 27 | M14X1,5 | 29 | 18,5 | 30 |
| AG1 | 27 | M16X1,5</ | | | |